

PREMIUM LIST

PRE-TRIAL ENTRIES MUST BE RECEIVED BY WEDNESDAY 6:00 PM, NOV 11th 2020
AT THE FIELD TRIAL SECRETARY'S ADDRESS

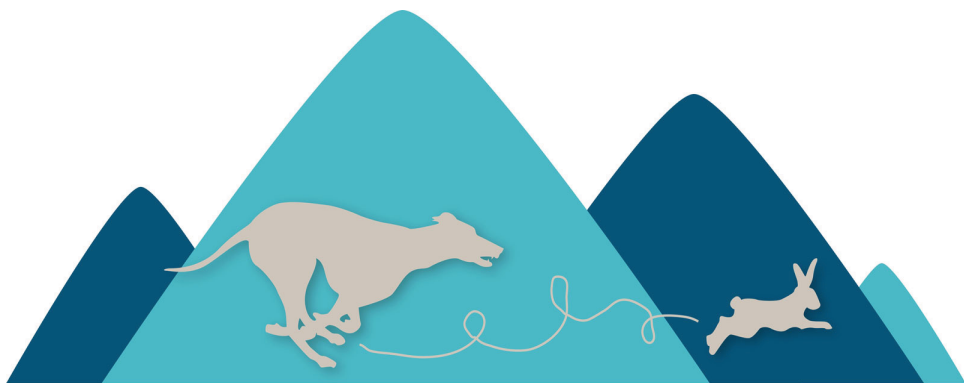

Gazehound Association of the Smoky Mountains

ASFA ALL-BREED FUN TRIAL

NO ASFA POINTS SHALL BE AWARDED AT THIS FUN TRIAL

A minimum of 12 entries are required

Friday November 13th, 2020

Region 7

Kominek Farm

99 Glendale Rd., Limestone, TN 37681



*Permission has been granted by the
American Sight hound Field Association for the holding of this
event under ASFA Rules and Regulations.
Audrey Silverstein, Chairperson, ASFA Scheduling Committee*

All Hounds entering Open, Veteran or Limited Stakes for the first time MUST include a completed ASFA Certification Form or Waiver Form and a copy of the hound's registration certificate (registration requirement waived for NGA Greyhounds; certification waived for Single Stake entries only).

Pre-Trial Entry Fees	\$5.00 per hound
Day of Trial Entry Fees	\$5.00 all hounds entered all stakes

Trial Hours 12:00 pm UNTIL COMPLETE

GASM Officers

President	Eddie Kominek
Vice President	Selma Kominek
Treasurer	Mike Terry
Secretary	Emily Killian
Board Members	Kristen Addington, Chuck Boyd, Claudia Haselton

Judges & Assignments

(* : provisional judge or breed | S : single judge | # : Canadian judge)

Donna Richards	8223 Lantana Dr., Denver, NC 28037
Mike Terry	1521 Coleman Bridge Rd., Wagener, SC 29164

Fri	A	AZ	BA	B	C	G	IB	IG	IW	P	R	S	SD	SL	SW	W	SGL	LTD
DR	x	x	x	x	x	x	x	x	x	x	x	x	x	x	x	x	x	x
MT	x	x	x	x	x	x	x	x	x	x	x	x	x	x	x	x	x	x

Field Committee

Field Trial Chairman	Emily Killian, 828-569-9575
Field Trial Secretary	Eddie Kominek, 123 Glendale Rd., Limestone, TN 37681 (c) 205-757-0290 eddie@kominekafghans.com
Inspection	Mallory Ballard, Kristen Fredericks, Deana McNamer, Mary Pick
Lure Operators	Chuck Boyd, Eddie Kominek

Trial Hours

Trial Hours: 12:00 PM until after ribbons are awarded.

Day of Trial entries close at 1:00 PM

Substitutions (same owner) until: 1:00 PM

Trial Roll Call: 1:00 PM ALL BREEDS, (Earlier for Field Committee, if available)

Conditions of Entry

All entries must be one year or older on the day of the trial ● Stakes will be split into flights by public random draw if the entry in any regular stake is 20 or more ● Bitches in season, lame hounds and hounds with breed disqualifications will be excused at roll call. Spayed, neutered, monorchid or cryptorchid hounds without breed disqualifications may be entered; hounds with breed disqualifications are not eligible to enter except in the Single Stake ● Hounds not present at the time of roll call will be scratched ● All hounds will run twice, in trios if possible or braces (except in the Single Stake), unless excused, dismissed or disqualified.

You will be expected to have complete info on your dog for each entry.

Incomplete entries and those submitted by E-MAIL WILL NOT BE ACCEPTED.

Regular ENTRIES WILL NOT BE ACKNOWLEDGED BY MAIL or EMAIL

Eligible Breeds and Registry

Only purebred Afghan Hounds, Azawakhs, Basenjis, Borzoi, Cirneco dell'Etna, Greyhounds, Ibizan Hounds, Irish Wolfhounds, Italian Greyhounds, Pharaoh Hounds, Rhodesian Ridgebacks, Salukis, Scottish Deerhounds, Silken Windhounds, Sloughis, Whippets may be entered in the regular stakes.

Limited breeds may be entered in the Limited Stake or the Singles Stake. Limited breeds currently include purebred Chart Polski, Galgo Español, Magyar Agar, Peruvian Inca Orchid, Portuguese Podengo (Pequeno), Portuguese Podengo (Medio & Grande), and must be individually registered with the appropriate registry.

All entries shall be individually registered with the AKC (ILP/PAL included), the NGA, the UKC, the FCI, an ASFA-recognized foreign or ASFA Board approved registry, or possess a CRN from the SPDBS. A photocopy of acceptable registry must be submitted with each hound's first ASFA field trial entry; this requirement is waived for hounds registered with the NGA.

Ribbons & Prizes

(All ribbons and prizes are donated by GASM except where noted)

Not available

Regular Stakes Offered

OPEN STAKE: Any eligible sighthound, excluding ASFA Field Champions of record record that has met the certification requirements.

FIELD CHAMPION STAKE: Any ASFA Field Champion

VETERAN STAKE: Any eligible hound whose age is at least six years, except Irish Wolfhounds whose age shall be at least five years, and Afghan Hounds, Rhodesian Ridgebacks, Salukis and Whippets whose age shall be at least seven years, record that has obtained met the certification requirements. Points go toward V-FCh or V-LCM titles.

LIMITED STAKE: Any eligible sighthound of a Limited breed that has met certification requirements. Not eligible to compete in Best of Breed or Best in Field.

SINGLES STAKE: Any eligible sighthound including those disqualified to run in other stakes. Each hound runs alone. Not eligible for Best of Breed or Best in Field. Hounds are eligible to earn TCP and CPX titles from the Singles stake. Limited breeds are not eligible for these titles.

BEST IN FIELD (BIF) will NOT be offered.

Emergency Veterinarian

Robinson Animal Hospital, 3026 Peoples St, Johnson City, TN 37604— (26 min)

423-218-1305—open 24/7 Fri-Sun

Turn left onto Glendale for 4.2 miles. Merge onto TN-81 for 1 mile. Turn left onto TN-75 N for 7.5 miles. Merge onto I26 E for 5.7 miles. Take exit 19, turn right onto TN-381 for .3 mi, left before Panera/Best Buy. Left at stop, Robinson on the left opposite K-Mart.

Airport Pet Emergency Clinic, 2436 Highway 75, Blountville, TN 37617—(30 min)

423-279-0574—open 24/7

Turn left onto Glendale for 4.2 miles. Merge onto TN-81 for .9 miles. Left onto TN75 at Marathon for 14.4 miles.

Emergency Medical

Johnson City Medical Center, 400 N. State of Franklin Rd., Johnson City, TN 37604

423-431-6111

Turn left onto Glendale for 4.2 miles. Merge onto TN-81 for 6.5 miles. Continue onto W. College St. Turn left onto Washington Dr. Turn right on W. Jackson Blvd/US11E for 5.5 miles. Turn right onto N State of Franklin Rd for .6 mi.

Food

Breakfast and Lunch: will not be available for purchase.

Please plan ahead and pack your own food

Dinner/Party: Due to COVID-19, there will be no scheduled gatherings. (We're super sad about this, but there's not really a safe way to do them.)

Camping

RV's are welcome; there are no hookups. Overnight camping will be permitted. Grills and small campfires are permitted. Fires must be extinguished before retiring. Canned fire extinguishers must be in possession when starting any fire.

Vendors

Vendors are always welcome, and there is no setup charge. Please ask the Field Trial Committee for suggests on where to setup. Prize donations for Best in Field/Breed prizes are always appreciated by the club, but not necessary.

Practice

We will hold practice on Friday and Saturday after the trials are complete for \$3/run.

Directions—GPS/MAP TO “99 Glendale Rd., Limestone TN 37681”

Expect 20-30 minute travel times from most hotels. Google Maps works well. Verizon has the best cell coverage, but reception on the field may be spotty.

From I-81 (N, E, W) (12 mins): NEVER USE EXIT 44. Take exit 50 for TN-93 south for 1.8 miles. Continue straight onto TN-81 for 2.2 miles. Right on Cherry Hill Rd for .6 miles. Bear left to Martin Rd. for .9 miles. Right on Glendale for 2.7 miles.

From I-26 (S) (40 mins): Take exit 37 north on TN-107/TN-81 for about 22 miles. Follow signs for TN-81N through Jonesborough. After passing the Marathon, keep an eye out for a sharp right turn, where you’ll continue straight onto Pleasant Grove Rd. for .8 miles. Turn right onto Glendale Rd for 3.4 miles.

RV NOTICE! Highly advised that you come in via: I26 -> Hwy 75S (Exit 13, Gray) -> Hwy 81N -> Glendale Rd. Any other way will have turns/roads you will NOT want to take a rig or trailer down.

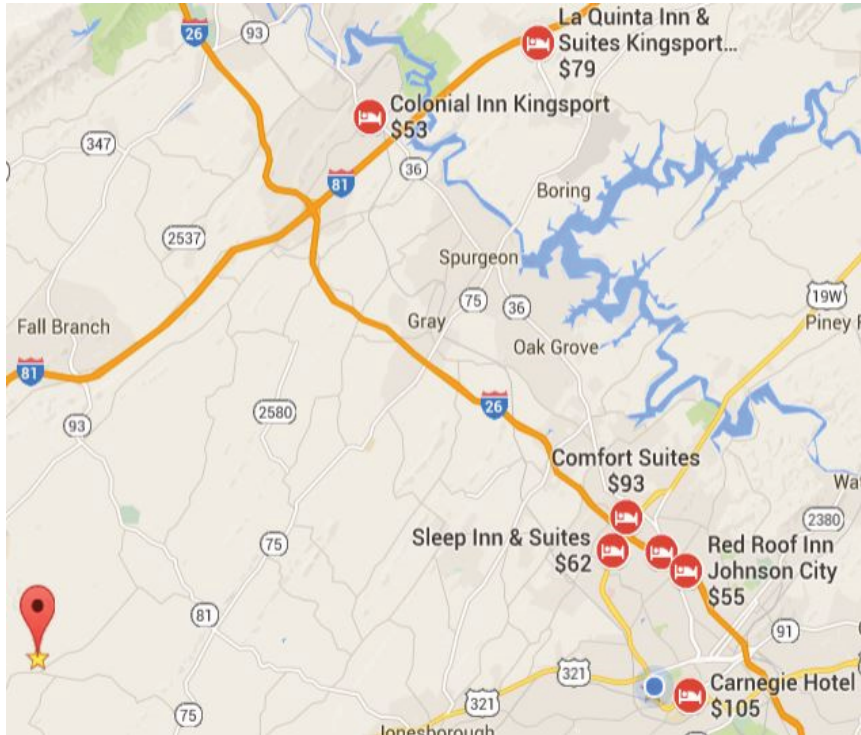

Motel Accommodations

La Quinta Inn & Suites (25 min) 10150 Airport Pkwy Kingsport, TN 37663 423-323-0500 ~\$79, Pets stay free	Red Roof Inn (31 min) 210 Broyles Dr. Johnson City, TN 37601 423-282-3040 ~\$55, Pets stay free	Colonial Inn Kingsport (22 min) 4234 Fort Henry Dr. Kingsport, TN 37663 423-239-3400 ~49, \$10/pet/night
Econo Lodge (25 min) 9980 Airport Pkwy Kingsport, TN 37663 423-279-7111 ~\$55, \$10/pet/night limit:2	Knights Inn (21 min) 121 Serral Dr. Greeneville, TN 37745 423-638-1331 ~\$45, \$10 pet fee	Quality Inn (21 min) 3160 E. Andrew Johnson Hwy Greeneville, TN37745 423-638-7511 ~72, \$20 pet fee

Property Map

For the east field, “Big Pretty,” you will enter Gate 1 which is a bit further west down Glendale, **99 Glendale Rd.** if you’re using GPS. Signs will be posted for directions. Stay on the gravel drive. RV’s will be able to make it out to the field, but we plan on having shaded areas for the RV’s and some cars to park in off the field. In case of loss of traction, a tractor and loader will be on hand for assistance.



Field & Course Plans

- The field has little shade and has natural and fence boundaries, entrance will be unobstructed.
- Please bring your own shade and water.
- High temperatures this time of year are historically below 85 degrees. We will start early and hopefully be done early.
- Battery powered, continuous loop lure machines will be used. The lure will consist of plastic strips. The members of the Gazehound Association of the Smoky Mountains reserve the right to alter the course plan as required by weather and/or field conditions on the day of the trial.
- Any person, upon reasonable complaint, may be asked to leave the grounds of the field trial by the Field Committee and may be disciplined by the ASFA. Children must be under control of their parent(s) or guardian(s) at all times.
- Neither Kominek Farms nor GASM and its members will be held responsible for any accidents at this trial.
- Please pick up after yourself and dogs and dispose of all trash/waste.
- Do not throw anything away into the porti-potties that shouldn't be in there (ie. Poop bags).
- Do not throw non-flushable Lysol/Clorox/sanitizing wipes into the portipotties.

Upcoming Trials

November 27-29 2020

AKC Tests & Trials

@Flintrock Farm - Reidsville, NC

By [Mid-Atlantic Hound Association](#)

December 5-6 2020

AKC Tests & Trial

@Parks Farm—Canon, GA

By [Greyhound Assoc of North Georgia](#)

December 26-28 2020

AKC Tests & Trials

@Kominek Farm—Limestone, TN

By [Gazehound Association of the Smoky Mountains](#)

December 29-31 2020

AKC Tests & Trials

@Kominek Farm—Limestone, TN

By [Mid-Atlantic Hound Association](#)

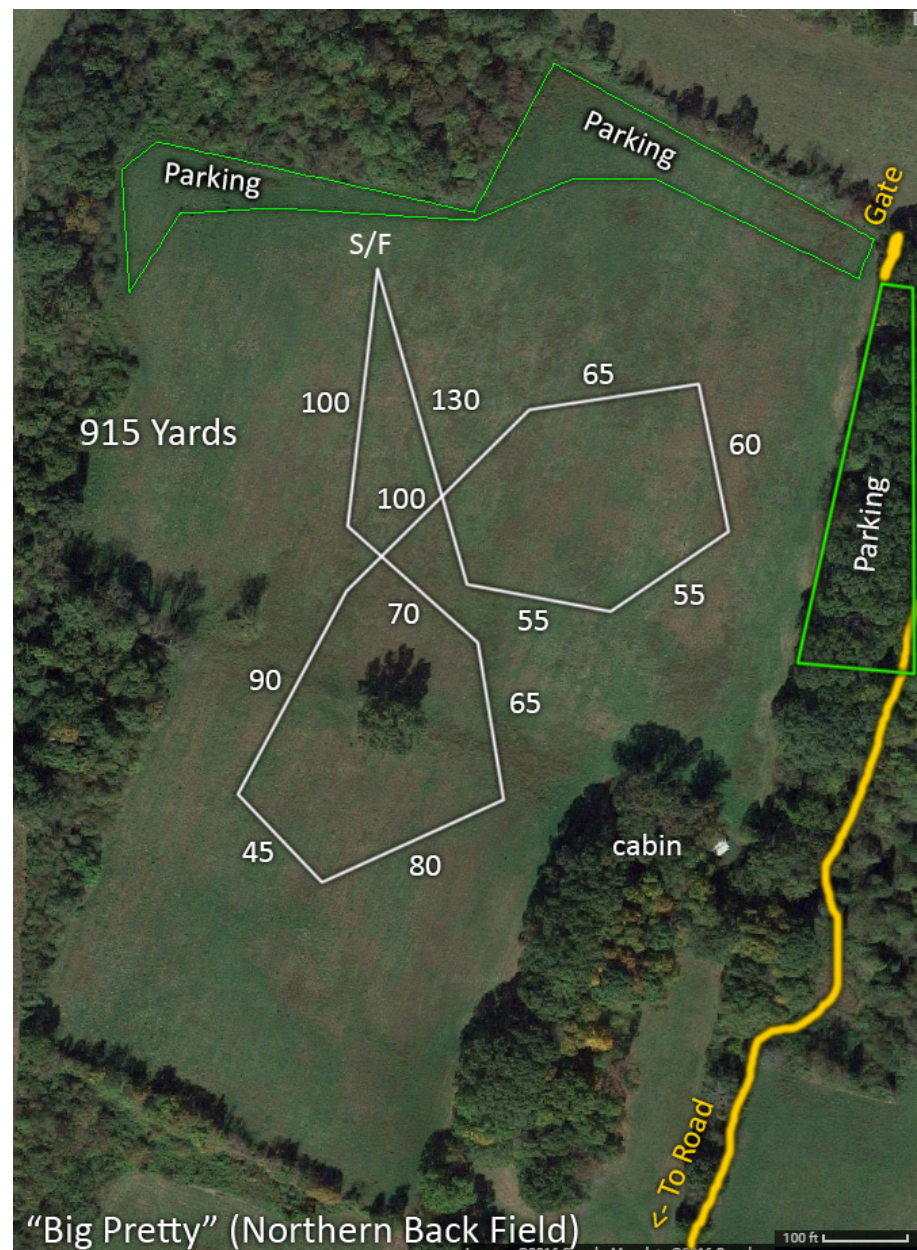

“Big Pretty” (Northern Back Field)

Friday — 915 yards
November 13, 2020

OFFICIAL AMERICAN SIGHTHOUND FIELD ASSOCIATION ENTRY FORM

POINTS AND PLACEMENTS DO NOT COUNT FOR THIS FUN TRIAL

Gazehound Association of the Smoky Mountains

Friday, November 13 2020

Early entries close 6:00 PM Wednesday, November 11 2020 at the FTS's residence.

Early entry fees: \$5.00; Day of trial entry fee: \$5.00;

(Substitutions, same owner, until November 13th, 2020 1:00 PM)

Make checks payable (in US funds) to Gazehound Assoc of the Smoky Mountains and mail to:

Eddie Kominck - FTS • 123 Glendale Rd., Limestone, TN 37681

Fee Paid _____ The Field Secretary cannot accept conditional, unsigned, incomplete or unpaid entries; please check your completed entry carefully.

Breed:		Call Name:	
Registered Name of Hound:			
Stake: <input type="checkbox"/> Open <input type="checkbox"/> FCH <input type="checkbox"/> Veteran <input type="checkbox"/> Single <input type="checkbox"/> Limited		Additional Stakes <input type="checkbox"/> Kennel <input type="checkbox"/> Breeder <input type="checkbox"/> Bench	
Registration Number: (please write in registering body before number)			
<input type="checkbox"/> If possible, please separate my hounds	Date of Birth:	Sex: <input type="checkbox"/> Dog <input type="checkbox"/> Bitch	
Name of actual owner(s):			
Address:		Phone:	
City:		State:	Zip:
E-mail (Optional)		(Optional) Region of Residence:	
Emergency Contact Name and Phone (Optional)			
<input type="checkbox"/> Check if this is the first ASFA trial for this hound. Attach a Hound Certification or waiver if entered in Open, Veterans, Limited.			
<input type="checkbox"/> Check if this is a first-time entry, a copy of the official Registration of this hound must accompany this entry unless NGA.			
<input type="checkbox"/> Check if any information has changed since the last ASFA trial entry. Regarding _____			
<input type="checkbox"/> Check if this hound has been dismissed within the last 6 trials entered. Must be marked in order to qualify for a "clean" trial requirement.			

NO ASFA POINTS SHALL BE AWARDED FOR THIS **FUN TRIAL**.

I CERTIFY that I am the actual owner of this dog, or that I am the duly authorized agent of the actual owner whose name I have entered above. In consideration of the acceptance of this entry and the opportunity to have this dog judged and to win prize money, ribbons, or trophies, I (we) agree to abide by the rules and regulations of the American Sighthound Field Association in effect at the time of this lure field trial, and by any additional rules and regulations appearing in the premium list for this lure field trial. I (we) agree that the club holding this lure field trial has the right to refuse this entry for cause, which the club shall deem to be sufficient. I (we) agree to hold this club, its members, directors, governors, officers, agents or other functionaries, any employees of the aforementioned parties and the owner(s) of the trial premises or grounds harmless from any claim for loss or injury which may be alleged to have been caused directly or indirectly to any person or thing by the act of this dog while in or upon the lure field trial premises or grounds or near any entrance thereto and I (we) personally assume all responsibility and liability for any such claim, and I (we) further agree to hold the aforementioned parties harmless from any claim loss of this dog by disappearance, theft damage or injury be caused or alleged to be caused by the negligence of the club or any of the aforementioned parties or by the negligence of any person or any other cause or causes. I (we) certify and represent that the dog entered is not a hazard to person or other dogs. This entry is submitted for acceptance of the forgoing representations and agreements

SIGNATURE of owner or his agent
duly authorized to make this entry _____

Please separate the entries before submitting to FTS.

For First Time Coursers and Handlers

- **WHAT ARE PRE-ENTRIES?** - Entries made before the closing date. If your entry is mailed in time yet due to the failure of the postal service it is not received in time for the Test Secretary to have it at the Event, then you will have to fill out day of entry forms on the day of the trial. Always have your dog's registration materials with you when you go to a test.
- **WHAT ARE "DAY OF" ENTRIES?** - Entries accepted after the closing date for pre-entries are considered Day of Entries. The deadline for Pre-entries is typically two days before the event. "Day of" entries are usually more expensive because the Field Test Secretary (FTS) must take extra time to add those entries to the record sheets the morning of the test, which delays the start of the trial. If you are entering on the day of the test, you MUST have your completed entry to the Test Secretary BEFORE Roll Call.
- **SLIP LEADS** - There is a type of collar for coursing called a slip lead, which is worn only to control the dog prior to release. The collar drops away as the dog is released to chase the lure and they run without anything around their necks that could be dangerous. **SLIP LEADS WILL BE PROVIDED**
- **INSPECTION** - Dogs will be inspected by a designated Inspection Committee consisting of at least two persons who are members of the Field Committee and who shall inspect each entered dog for lameness, fitness to compete and female estrus (in season). Inspection shall take place prior to any form of wrapping being applied to the dog. In the opinion of the Inspection Committee, any entry found to be lame, unfit to compete or in season shall not be allowed to enter and the applicable entry fees shall be refunded.
- **ROLL CALL** - The time, prior to the commencement of coursing, by which you are supposed to have your dog ready for inspection by the Inspection Committee. At roll call the dog is examined for lameness, and breed disqualifications (where applicable). Unspayed bitches are examined to see if they show any evidence of being in season. After roll call the list of passed hounds is taken to the Field Test Secretary so that the run order can be prepared.
- **RUN ORDER LIST** - This is a posted list of the running order for the dogs participating in the event. Always check the record sheet after the Roll Call to confirm your dog's Run Order.

OFFICIAL AMERICAN SIGHTHOUND FIELD ASSOCIATION ENTRY FORM
POINTS AND PLACEMENTS DO NOT COUNT FOR THIS FUN TRIAL

Gazehound Association of the Smoky Mountains

Friday, November 13 2020

Early entries close 6:00 PM Wednesday, November 11 2020 at the FTS's residence.

Early entry fees: \$5.00; Day of trial entry fee: \$5.00;

(Substitutions, same owner, until November 13th, 2020 1:00 PM)

Make checks payable (in US funds) to Gazehound Assoc of the Smoky Mountains and mail to:

Eddie Kominek - FTS • 123 Glendale Rd., Limestone, TN 37681

**AMERICAN SIGHTHOUND FIELD ASSOCIATION
HOUND CERTIFICATION**

Rule effective October 1, 1994: Ch. V, Sec. 4 (a) OPEN STAKE: *To be eligible to enter the open stake, a hound must have been certified by a licensed judge within the year preceding the closing date for the entry or have previously competed in the Open Stake.* This eligibility requirement also applies to a hound entered in the Limited or Veteran Stake, which has not competed in Open previously. Please complete this portion of this form and attach it to the entry form for the hound's first entry, including an entry for a Fun Trial.

Registered Name of Hound: _____

Registration Number: _____ Breed: _____

Registered Owner's Name: _____

I hereby certify that on (date) _____, the above named hound completed a lure course of at least 500 yards, running with another hound of the same breed (or another breed with a similar running style). During the course the above named hound showed no inclination to interfere with the other hound. I further certify that I am a licensed judge for the ASFA.

Name of Licensed Judge: _____

Signature: _____ Date: _____

I hereby certify that the hound running in the certification course is the hound identified above and that information provided on this form is true and correct.

Signature: _____ Date: _____

Owner or Authorized Agent of Hound

This certification form must be attached to the entry form the first time this hound is entered in an open, limited, or veteran stake. Any hound entered in open, limited, or veteran (as a first time entered hound), which has not been certified, shall be declared ineligible by the records coordinator and shall forfeit any points and placements awarded.

PLEASE RETAIN A COPY FOR YOUR RECORDS.

**AMERICAN SIGHTHOUND FIELD ASSOCIATION
HOUND CERTIFICATION WAIVER**

Waiver of Requirement: *This requirement will be waived for a hound that has earned a lure coursing title from another recognized organization, if such title requires competition, and if a waiver for such title has been approved by the ASFA, or a CKC Hound Certification Form.* If your hound qualifies for a waiver, complete this portion of this form and attach it to your entry form. Proof of waivers must accompany this certification form.

Registered Name of Hound: _____

Registration Number: _____ Breed: _____

Registered Owner's Name: _____

CKC: FCH FCHX

AKC: QC SC FC

Hound Certification previously submitted.

I hereby certify that the hound identified above has completed the requirements for the title indicated above (or that the required Certification was previously submitted) and that the information provided on this form is true and correct.

Signature: _____ Date: _____

Owner or Authorized Agent of Hound

Fee Paid _____ The Field Secretary cannot accept conditional, unsigned, incomplete or unpaid entries; please check your completed entry carefully.

Breed:		Call Name:	
Registered Name of Hound:			
Stake: <input type="checkbox"/> Open <input type="checkbox"/> FCH <input type="checkbox"/> Veteran <input type="checkbox"/> Single <input type="checkbox"/> Limited		Additional Stakes <input type="checkbox"/> Kennel <input type="checkbox"/> Breeder <input type="checkbox"/> Bench	
Registration Number: (please write in registering body before number)			
<input type="checkbox"/> If possible, please separate my hounds	Date of Birth:	Sex: <input type="checkbox"/> Dog <input type="checkbox"/> Bitch	
Name of actual owner(s):			
Address:		Phone:	
City:		State:	Zip:
E-mail (Optional)		(Optional) Region of Residence:	
Emergency Contact Name and Phone (Optional)			
<input type="checkbox"/> Check if this is the first ASFA trial for this hound. Attach a Hound Certification or waiver if entered in Open, Veterans, Limited.			
<input type="checkbox"/> Check if this is a first-time entry, a copy of the official Registration of this hound must accompany this entry unless NGA.			
<input type="checkbox"/> Check if any information has changed since the last ASFA trial entry. Regarding _____			
<input type="checkbox"/> Check if this hound has been dismissed within the last 6 trials entered. Must be marked in order to qualify for a "clean" trial requirement.			

NO ASFA POINTS SHALL BE AWARDED FOR THIS **FUN TRIAL.**

I CERTIFY that I am the actual owner of this dog, or that I am the duly authorized agent of the actual owner whose name I have entered above. In consideration of the acceptance of this entry and the opportunity to have this dog judged and to win prize money, ribbons, or trophies, I (we) agree to abide by the rules and regulations of the American Sighthound Field Association in effect at the time of this lure field trial, and by any additional rules and regulations appearing in the premium list for this lure field trial. I (we) agree that the club holding this lure field trial has the right to refuse this entry for cause, which the club shall deem to be sufficient. I (we) agree to hold this club, its members, directors, governors, officers, agents or other functionaries, any employees of the aforementioned parties and the owner(s) of the trial premises or grounds harmless from any claim for loss or injury which may be alleged to have been caused directly or indirectly to any person or thing by the act of this dog while in or upon the lure field trial premises or grounds or near any entrance thereto and I (we) personally assume all responsibility and liability for any such claim, and I (we) further agree to hold the aforementioned parties harmless from any claim loss of this dog by disappearance, theft damage or injury be caused or alleged to be caused by the negligence of the club or any of the aforementioned parties or by the negligence of any person or any other cause or causes. I (we) certify and represent that the dog entered is not a hazard to person or other dogs. This entry is submitted for acceptance of the forgoing representations and agreements

SIGNATURE of owner or his agent
duly authorized to make this entry _____

Please separate the entries before submitting to FTS.

“Big Pretty”

Northwestern 24 acre field with some terrain and great views.



Cabin

Off-grid cabin with loft and fenced dog yard potentially available for camping. Contact FTS for details and availability.



14



COVID-19 Guidelines

1. GASM, its club members and all exhibitors will follow [State](#) and [local](#) guidelines.
2. All Field Committee and Lure Operators will wear facial coverings and gloves.
3. All participants will wear facial coverings.
4. No food will be served, bring your own breakfast and lunches. Please bring your own food, water and shade for yourself and your dogs.
5. We ask that you park at a safe distance away from each other.
6. Roll Call will be done at everyone's car, instead of a central location. The roll call committee will wear gloves and facial coverings. We will ask the owners of females to wipe their dogs and show the inspection committee the tissue.
7. The temperatures of exhibitors may be checked during Roll Call or when in question using a forehead, no-touch thermometer. Anyone with a temperature of 100.4°F or higher will be considered febrile and asked to leave the property.
8. Wickets will be wiped down after each dog.
9. We will have hand washing stations, instant hand sanitizer or wet wipes in various locations for use.
10. We will prop open the portipotties when not in use for more air flow.
11. Huntmasters will stand 6 feet from the dogs inspecting blankets and slip leads.
12. At the starting line, all exhibitors will stand 6 feet apart from one another.
13. Practice social distancing the best you can.
14. While the running order and scores will be posted as usual, we will use a PA system to notify you if you choose to stay by your car. We ask that exhibitors approach the sheets one at a time and maintain social distance guidelines.
15. An SMS system will likely be used to notify exhibitors of their upcoming course.
16. We will also post running orders and scoresheets on our Facebook page: <https://www.facebook.com/GazehoundAssocSmkyMtns/>
17. No self-serve ribbons anymore due to cross contamination.
18. These trials will be pre-entry only. If your dog QC's one of the days and you would like to enter them in the trials, let the FTS know and pay via PayPal. Checks and cash will not be accepted day-of.
19. We will not be accepting any day-of entries or payments for entries, practice runs or anything. If any payments need to be made, a PayPal to paypal@gasm.club will be accepted.
20. Exhibitors who refuse to comply when reasonably asked to follow mask, sanitary or social distancing guidelines will be removed from the property.

15



Gazehound Association of the Smoky Mountains

Eddie Kominek, FTS

123 Glendale Rd.

Limestone, TN 37681