

## PREMIUM LIST

TRIAL ENTRIES MUST BE RECEIVED BY FRIDAY 6:00 PM, DECEMBER 24<sup>th</sup> 2021  
AT THE FIELD TRIAL SECRETARY'S ADDRESS

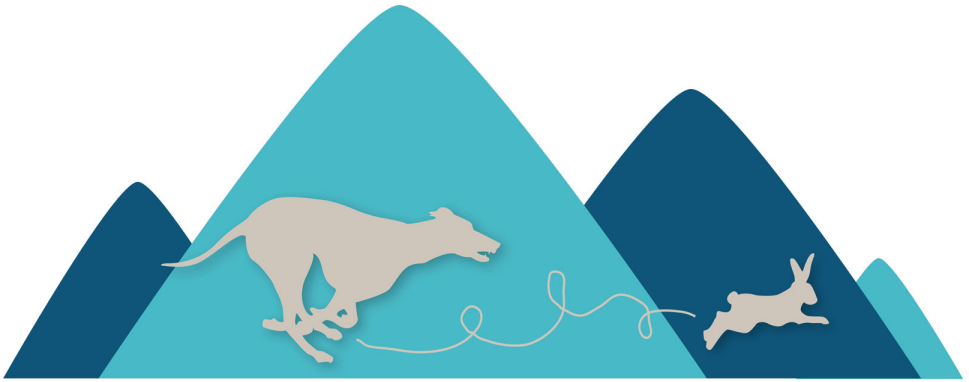

# Gazehound Association of the Smoky Mountains

## ASFA SILKEN WINDHOUND SPECIALTY FIELD TRIAL

**Wednesday December 29<sup>th</sup>, 2021**

**Thursday December 30<sup>th</sup>, 2021**

**Friday December 31<sup>st</sup>, 2021**

**Saturday January 1<sup>st</sup>, 2022**

Region 7

[Kominek Farm](#)

[99 Glendale Rd., Limestone, TN 37681](#)



*Permission has been granted by the  
American Sight hound Field Association for the holding of this  
event under ASFA Rules and Regulations.*

*Audrey Silverstein, Chairperson, ASFA Scheduling Committee*

All Hounds entering Open, Veteran or Provisional Stakes for the first time MUST include a completed ASFA Certification Form or Waiver Form and a copy of the hound's registration certificate (certification waived for Single Stake entries only).

<b>Pre-Trial Entry Fees</b>	\$20.00 for first hound entered \$17.00 for second hound, same household/owner \$14.00 for each additional hound, same household/owner.
<b>Day of Trial Entry Fees</b>	\$25.00 all hounds entered all stakes

Trial Hours 6:00 AM UNTIL COMPLETE

## GASM Officers

President	Eddie Kominek
Vice President	Selma Kominek
Treasurer	Jeanai Ranero
Secretary	Emily Killian



## Judges & Assignments

(\* : provisional judge or breed | + : single judge)

Matt Coughlin	2306 Ohio Dr., Orlando, FL 32803
Justin Dannenbring	5570 Fireweed Loop, Helena, MT 59602
Darci Kunard	17531 E 104 <sup>th</sup> Pl., Commerce City, CO 80022
*Wayne Olson*	21690 CO Hwy E, Cornell, WI 54732

	Wednesday	Thursday	Friday	Saturday
Silken Windhounds	DK	JD, WO*	DK, WO*	MC, WO*
Singles (SW Only)	DK	JD, WO*	DK, WO*	MC, WO*

## Field Committee

Chairman	Emily Killian, 828-569-9575
Secretary	Eddie Kominek, 123 Glendale Rd., Limestone, TN 37681 (c) 205-757-0290 <a href="mailto:fts@gasm.club">fts@gasm.club</a>
Trial Committee	Jeanai Ranero, Deana McNamer, Mary Pick, Crystal Slattery, Jerry Slattery
Lure Operators	Chuck Boyd, Eddie Kominek, Hannah Pemberton, Jerry Slattery
Hunt Masters	Hannah Pemberton, John Antonik

## Trial Hours

**Trial Hours: 6:00 AM until after ribbons are awarded.**

**Substitutions (same owner) until: 7:00 AM**

**Trial Roll Call: 7:00 AM, (Earlier for Field Committee, if available)**

## Conditions of Entry

All entries must be one year or older on the day of the trial • Stakes will be split into flights by public random draw if the entry in any regular stake is 20 or more • Bitches in season, lame hounds and hounds with breed disqualifications will be excused at roll call. Spayed, neutered, monorchid or cryptorchid hounds without breed disqualifications may be entered; hounds with breed disqualifications are not eligible to enter except in the Single Stake • Hounds not present at the time of roll call will be scratched • All hounds will run twice, in trios if possible or braces (except in the Single Stake), unless excused, dismissed or disqualified.

You will be expected to have complete info on your dog for each entry.

Incomplete entries and those submitted by E-MAIL WILL NOT BE ACCEPTED.

Regular ENTRIES WILL NOT BE ACKNOWLEDGED BY MAIL or EMAIL

## ONLINE ENTRIES AND PAYMENT:

<https://entries.gasm.club>

## Eligible Breeds and Registry

Only purebred Silken Windhounds may enter. All entries shall be individually registered with the Silken Registry (ISWS), UKC, an ASFA recognized foreign or ASFA Board approved registry

## Ribbons & Prizes

(All ribbons and prizes are donated by GASM except where noted)

1 <sup>st</sup> - 4 <sup>th</sup> Placements, NBQ	Blue, Red, Yellow, White or Green ribbon
High Scoring Single	Navy and Gold Rosette
Best of Breed (All)	Purple and Gold rosette
	Squeaky toy

### Regular Stakes Offered

**OPEN STAKE:** Open to any eligible Silken Windhound excluding ASFA Field Champions of record, that have met certification requirements.

**FIELD CHAMPION STAKE:** Open to Silken Windhound ASFA Field Champions.

**VETERAN STAKE:** Open to any eligible Silken Windhound whose age is over 6 years, on the day of the trial. Points and placements go towards the V-FCh and V-LCM titles.

**SINGLE STAKE:** Open to any eligible Silken Windhound including those disqualified to run in other stakes. They are not eligible for Best of Breed or Best in Field. Hounds are eligible to earn TCP and CPX titles from the Singles Stake. Hounds will run alone.

**BEST IN FIELD (BIF) will NOT be offered.**



### Emergency Veterinarian

**Robinson Animal Hospital, 3026 Peoples St, Johnson City, TN 37604— (26 min)  
423-218-1305—open 24/7 Fri-Sun**

Turn left onto Glendale for 4.2 miles. Merge onto TN-81 for 1 mile. Turn left onto TN-75 N for 7.5 miles. Merge onto I26 E for 5.7 miles. Take exit 19, turn right onto TN-381 for .3 mi, left before Panera/Best Buy. Left at stop, Robinson on the left opposite K-Mart.

**Airport Pet Emergency Clinic, 2436 Highway 75, Blountville, TN 37617—(30 min)  
423-279-0574—open 24/7**

Turn left onto Glendale for 4.2 miles. Merge onto TN-81 for .9 miles. Left onto TN75 at Marathon for 14.4 miles.

### Emergency Medical

**Johnson City Medical Center, 400 N. State of Franklin Rd., Johnson City, TN 37604  
423-431-6111**

Turn left onto Glendale for 4.2 miles. Merge onto TN-81 for 6.5 miles. Continue onto W. College St. Turn left onto Washington Dr. Turn right on W. Jackson Blvd/US11E for 5.5 miles. Turn right onto N State of Franklin Rd for .6 mi.

### Food

#### Lunch:

We plan on grilling out hamburgers and hot dogs with turkey burgers and veggie burgers available upon request. Burger, chips and a drink will run you \$5.

#### Friday Dinner:

Big Party! Hors d'oeuvres. New Years traditional dinner courtesy of Eddie & Selma Kominek up at the house, starting at 6PM.

### Camping

RV's are welcome; there are no hookups. Overnight camping will be permitted. Grills and small campfires are permitted. Fires must be extinguished before retiring. Canned fire extinguishers must be in possession when starting any fire.

### Vendors

Vendors are always welcome, and there is no setup charge. Please ask the Field Trial Committee for suggests on where to setup. Prize donations for Best in Field/Breed prizes are always appreciated by the club, but not necessary.

### Practice

We will hold practice on Wednesday-Friday after the trials are complete for \$3/run.

**Directions—GPS/MAP TO “99 Glendale Rd., Limestone TN 37681”**

Expect 20-30 minute travel times from most hotels. Google Maps works well. Verizon has the best cell coverage, but reception on the field may be spotty.

**From I-81 (N, E, W) (12 mins): NEVER USE EXIT 44. Take exit 50** for TN-93 south for 1.8 miles. Continue straight onto TN-81 for 2.2 miles. Right on Cherry Hill Rd for .6 miles. Bear left to Martin Rd. for .9 miles. Right on Glendale for 2.7 miles.

**From I-26 (S) (40 mins):** Take exit 37 north on TN-107/TN-81 for about 22 miles. Follow signs for TN-81N through Jonesborough. After passing the Marathon, keep an eye out for a sharp right turn, where you’ll continue straight onto Pleasant Grove Rd. for .8 miles. Turn right onto Glendale Rd for 3.4 miles.

**BRIDGE OUT!:** The cement bridge from 81 to Providence Rd. is out! That means you will have to follow the the detour route to Oak Hill Cir.

**\*NEW\* RV NOTICE!:** Highly advised that you come in via: I81 -> Hwy 93 (Exit 50) -> Hwy 81N -> Oak Hill Cir (Across from Oak Hill Baptist Church) -> Oak Hill Rd. -> Martin Rd. -> Glendale Rd. Any other way will have turns/roads you will NOT want to take a rig or trailer down.

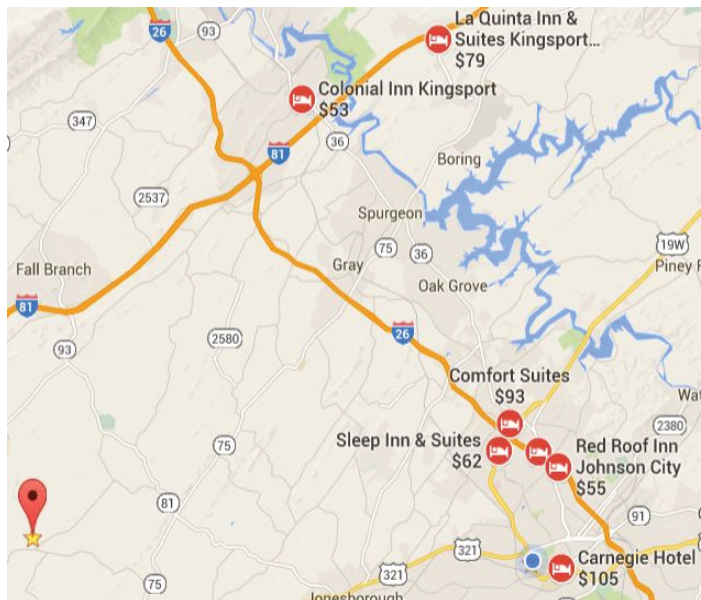

**Motel Accommodations**

<b>La Quinta Inn &amp; Suites</b> (25 min) 10150 Airport Pkwy Kingsport, TN 37663 423-323-0500 ~\$79, Pets stay free	<b>Red Roof Inn</b> (31 min) 210 Broyles Dr. Johnson City, TN 37601 423-282-3040 ~\$55, Pets free   limit:2	<b>Colonial Inn Kingsport</b> (22 min) 4234 Fort Henry Dr. Kingsport, TN 37663 423-239-3400 ~49, \$10/pet/night
<b>Econo Lodge</b> (25 min) 9980 Airport Pkwy Kingsport, TN 37663 423-279-7111 ~\$55, \$10/pet/night   limit:2	<b>Knights Inn</b> (21 min) 121 Serral Dr. Greeneville, TN 37745 423-638-1331 ~\$45, \$10 pet fee	<b>Quality Inn</b> (21 min) 3160 E. Andrew Johnson Hwy Greeneville, TN37745 423-638-7511 ~72, \$20 pet fee

**Property Map**

For the east field, “Big Pretty,” you will enter Gate 1 which is a bit further west down Glendale, **99 Glendale Rd.** if you’re using GPS. Signs will be posted for directions. Stay on the gravel drive. RV’s will be able to make it out to the field, but we plan on having shaded areas for the RV’s and some cars to park in off the field. In case of loss of traction, a tractor and loader will be on hand for assistance.





## Field & Course Plans

- The field has little shade and has natural and fence boundaries, entrance will be unobstructed.
- Please bring your own shade and water.
- Battery powered, continuous loop lure machines will be used. The lure will consist of plastic strips and/or fur strips. The members of the Gazehound Association of the Smoky Mountains reserve the right to alter the course plan as required by weather and/or field conditions on the day of the trial.
- Any person, upon reasonable complaint, may be asked to leave the grounds of the field trial by the Field Committee and may be disciplined by the ASFA. Children must be under control of their parent(s) or guardian(s) at all times.
- Neither Kominek Farms nor GASM and its members will be held responsible for any accidents at this trial.
- Please pick up after yourself and dogs and dispose of all trash/waste.
- Do not throw anything away into the porti-potties that shouldn't be in there (ie. Poop bags).
- Do not throw non-flushable Lysol/Clorox/sanitizing wipes into the portipotties.

## Friday Night New Years Dinner!

**Where:** Kominek House, 123 Glendale Rd.

**Cost:** Free!

**Time:** ~6:00 PM

**Menu:** Pork roast, black eyed peas, greens, and various sides

**Dessert:** CAKE!

**Drinks:** Large steel containers full of choice beverages and glass containers full of aged grape juice. You're also welcome to BYOB, but it won't be necessary. ;}

**Dirty Santa:** Wrapped gift valued at \$20 or more.



shutterstock · 30848689



Happy Holidays to everyone! In celebration of the season, we're hosting a dinner party at the house with everyone invited! We'll have roast, sides, cake and merry making!

After the food and drinks, we'll play a little **Dirty Santa** and see who the luckiest swapper is! Bring a wrapped gift worth at least \$20 to participate. Everyone will go home with something!

**Christmas Sighthound Drawing Contest!** Take a turn at the artist's easel and show us your version of a holiday hound! The best drawings evaluated by our judges will receive adult-oriented gifts! ;}

## Upcoming Events @ Kominek Farm

**January 8-9 2022**

**LGRA Race Meets**

@Kominek Farm—Limestone, TN

By [Gazehound Assoc of the Smky Mntns](#)

**February 19-20 2022**

**AKC Tests & Trials**

@Kominek Farm—Limestone, TN

By [Gazehound Assoc of the Smky Mntns](#)

**March 12-13 2022**

**LGRA Race Meets**

@Kominek Farm—Limestone, TN

By [Gazehound Assoc of the Smky Mntns](#)

**April 9-10 2021**

**ASFA Trials**

@Kominek Farm—Limestone, TN

By [Gazehound Assoc of the Smky Mntns](#)

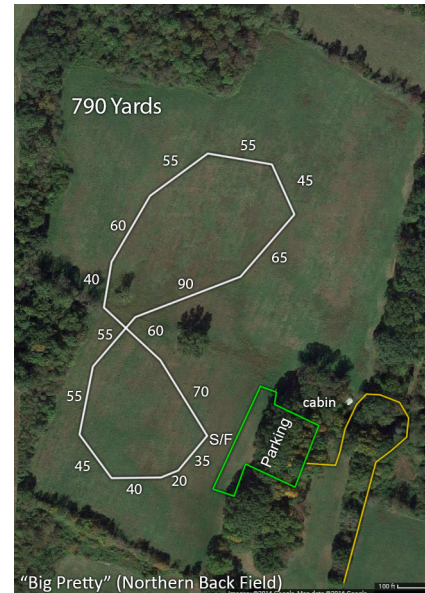

Wednesday — 790 yards  
December 29, 2021



Thursday — 895 yards  
December 30, 2021



Friday — 880 yards  
December 31, 2021

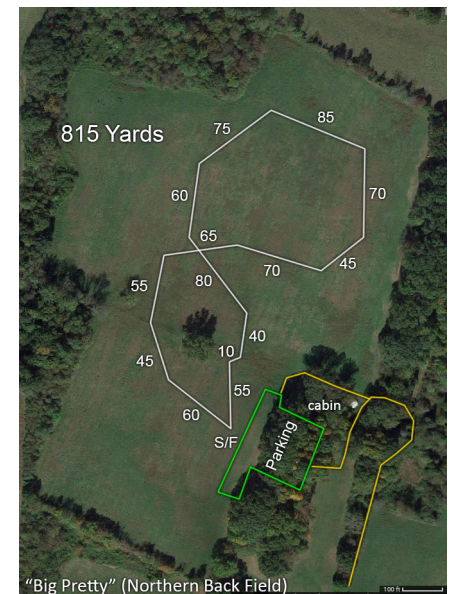

Saturday — 815 yards  
January 1, 2022

## OFFICIAL AMERICAN SIGHTHOUND FIELD ASSOCIATION ENTRY FORM

Gazehound Association of the Smoky Mountains

Wednesday, Dec 29 2021 \_\_\_\_\_ Thursday, Dec 30 2021 \_\_\_\_\_ Friday, Dec 31 2021 \_\_\_\_\_ Saturday, Jan 1 2022 \_\_\_\_\_

Early entries close 6:00 PM Friday, Dec 24 2021 at the FTS's residence.

Early entry fees: \$20.00 1<sup>st</sup> Hound, \$17.00 2<sup>nd</sup> Hound, \$14.00 each additional Hound. (All Same household)

Day of Trial Fee: \$25 per Hound

(Substitutions, same owner, until Dec 24, 2021 7:00 AM)

Make checks payable (in US funds) to Gazehound Association of the Smoky Mountains and mail to:

Eddie Kominek – FTS • 123 Glendale Rd., Limestone, TN 37681

Fee Paid \_\_\_\_\_ The Field Secretary cannot accept conditional, unsigned, incomplete or unpaid entries; please check your completed entry carefully.

Breed:	SILKEN WINDHOUND			Call Name:			
Registered Name of Hound:							
Stake:				Additional Stakes			
<input type="checkbox"/> Open <input type="checkbox"/> FCH <input type="checkbox"/> Veteran <input type="checkbox"/> Single <input type="checkbox"/> Provisional				<input type="checkbox"/> Kennel <input type="checkbox"/> Breeder <input type="checkbox"/> Bench			
Registration Number: (please write in registering body before number)							
<input type="checkbox"/> If possible, please separate my hounds		Date of Birth:		Sex:			
				<input type="checkbox"/> Dog <input type="checkbox"/> Bitch			
Name of actual owner(s):							
Address:				Phone:			
City:			State:	Zip:			
E-mail (Optional)				(Optional) Region of Residence:			
Emergency Contact Name and Phone (Optional)							
<input type="checkbox"/> Check if this is the first ASFA trial for this hound. Attach a Hound Certification or waiver if entered in Open, Veterans, Provisional.							
<input type="checkbox"/> Check if this is a first-time entry, a copy of the official Registration of this hound must accompany this entry unless NGA.							
<input type="checkbox"/> Check if any information has changed since the last ASFA trial entry. Regarding _____							
<input type="checkbox"/> Check if this hound has been dismissed within the last 6 trials entered. Must be marked in order to qualify for a "clean" trial requirement.							

I CERTIFY that I am the actual owner of this dog, or that I am the duly authorized agent of the actual owner whose name I have entered above. In consideration of the acceptance of this entry and the opportunity to have this dog judged and to win prize money, ribbons, or trophies, I (we) agree to abide by the rules and regulations of the American Sighthound Field Association in effect at the time of this lure field trial, and by any additional rules and regulations appearing in the premium list for this lure field trial. I (we) agree that the club holding this lure field trial has the right to refuse this entry for cause, which the club shall deem to be sufficient. I (we) agree to hold this club, its members, directors, governors, officers, agents or other functionaries, any employees of the aforementioned parties and the owner(s) of the trial premises or grounds harmless from any claim for loss or injury which may be alleged to have been caused directly or indirectly to any person or thing by the act of this dog while in or upon the lure field trial premises or grounds or near any entrance thereto and I (we) personally assume all responsibility and liability for any such claim, and I (we) further agree to hold the aforementioned parties harmless from any claim loss of this dog by disappearance, theft damage or injury be caused or alleged to be caused by the negligence of the club or any of the aforementioned parties or by the negligence of any person or any other cause or causes. I (we) certify and represent that the dog entered is not a hazard to person or other dogs. This entry is submitted for acceptance of the forgoing representations and agreements.

**SIGNATURE** of owner or his agent

duly authorized to make this entry \_\_\_\_\_

**Please separate the entries before submitting to FTS.**

## For First Time Coursers and Handlers

- **WHAT ARE PRE-ENTRIES?** - Entries made before the closing date. If your entry is mailed in time yet due to the failure of the postal service it is not received in time for the Test Secretary to have it at the Event, then you will have to fill out day of entry forms on the day of the trial. Always have your dog's registration materials with you when you go to a test.
- **WHAT ARE "DAY OF" ENTRIES?** - Entries accepted after the closing date for pre-entries are considered Day of Entries. The deadline for Pre-entries is typically two days before the event. "Day of" entries are usually more expensive because the Field Test Secretary (FTS) must take extra time to add those entries to the record sheets the morning of the test, which delays the start of the trial. If you are entering on the day of the test, you MUST have your completed entry to the Test Secretary BEFORE Roll Call.
- **SLIP LEADS** - There is a type of collar for coursing called a slip lead, which is worn only to control the dog prior to release. The collar drops away as the dog is released to chase the lure and they run without anything around their necks that could be dangerous. **SLIP LEADS WILL BE PROVIDED**
- **INSPECTION** - Dogs will be inspected by a designated Inspection Committee consisting of at least two persons who are members of the Field Committee and who shall inspect each entered dog for lameness, fitness to compete and female estrus (in season). Inspection shall take place prior to any form of wrapping being applied to the dog. In the opinion of the Inspection Committee, any entry found to be lame, unfit to compete or in season shall not be allowed to enter and the applicable entry fees shall be refunded.
- **ROLL CALL** - The time, prior to the commencement of coursing, by which you are supposed to have your dog ready for inspection by the Inspection Committee. At roll call the dog is examined for lameness, and breed disqualifications (where applicable). Unspayed bitches are examined to see if they show any evidence of being in season. After roll call the list of passed hounds is taken to the Field Test Secretary so that the run order can be prepared.
- **RUN ORDER LIST** - This is a posted list of the running order for the dogs participating in the event. Always check the record sheet after the Roll Call to confirm your dog's Run Order.

**OFFICIAL AMERICAN SIGHTHOUND FIELD ASSOCIATION ENTRY FORM**

Gazehound Association of the Smoky Mountains  
 Wednesday, Dec 29 2021 \_\_\_\_ Thursday, Dec 30 2021 \_\_\_\_ Friday, Dec 31 2021 \_\_\_\_ Saturday, Jan 1 2022 \_\_\_\_  
 Early entries close 6:00 PM Friday, Dec 24 2021 at the FTS's residence.  
 Early entry fees: \$20.00 1<sup>st</sup> Hound, \$17.00 2<sup>nd</sup> Hound, \$14.00 each additional Hound. (All Same household)

Day of Trial Fee: \$25 per Hound

(Substitutions, same owner, until Dec 24, 2021 7:00 AM)

Make checks payable (in US funds) to Gazehound Association of the Smoky Mountains and mail to:

Eddie Kominek – FTS • 123 Glendale Rd., Limestone, TN 37681

Fee Paid \_\_\_\_\_ The Field Secretary cannot accept conditional, unsigned, incomplete or unpaid entries; please check your completed entry carefully.

**AMERICAN SIGHTHOUND FIELD ASSOCIATION  
 HOUND CERTIFICATION**

**Rule effective October 1, 1994: Ch. V, Sec. 4 (a) OPEN STAKE:** *To be eligible to enter the open stake, a hound must have been certified by a licensed judge within the year preceding the closing date for the entry or have previously competed in the Open Stake.* This eligibility requirement also applies to a hound entered in the Limited or Veteran Stake, which has not competed in Open previously. Please complete this portion of this form and attach it to the entry form for the hound's first entry, including an entry for a Fun Trial.

Registered Name of Hound: \_\_\_\_\_

Registration Number: \_\_\_\_\_ Breed: \_\_\_\_\_

Registered Owner's Name: \_\_\_\_\_

I hereby certify that on (date) \_\_\_\_\_, the above named hound completed a lure course of at least 500 yards, running with another hound of the same breed (or another breed with a similar running style). During the course the above named hound showed no inclination to interfere with the other hound. I further certify that I am a licensed judge for the ASFA.

Name of Licensed Judge: \_\_\_\_\_

Signature: \_\_\_\_\_ Date: \_\_\_\_\_

I hereby certify that the hound running in the certification course is the hound identified above and that information provided on this form is true and correct.

Signature: \_\_\_\_\_ Date: \_\_\_\_\_

Owner or Authorized Agent of Hound

This certification form must be attached to the entry form the first time this hound is entered in an open, limited, or veteran stake. Any hound entered in open, limited, or veteran (as a first time entered hound), which has not been certified, shall be declared ineligible by the records coordinator and shall forfeit any points and placements awarded.

**PLEASE RETAIN A COPY FOR YOUR RECORDS.**

**AMERICAN SIGHTHOUND FIELD ASSOCIATION  
 HOUND CERTIFICATION WAIVER**

**Waiver of Requirement:** *This requirement will be waived for a hound that has earned a lure coursing title from another recognized organization, if such title requires competition, and if a waiver for such title has been approved by the ASFA, or a CKC Hound Certification Form. If your hound qualifies for a waiver, complete this portion of this form and attach it to your entry form. Proof of waivers must accompany this certification form.*

Registered Name of Hound: \_\_\_\_\_

Registration Number: \_\_\_\_\_ Breed: \_\_\_\_\_

Registered Owner's Name: \_\_\_\_\_

**CKC:** FCH FCHX

**AKC:** QC SC FC

Hound Certification previously submitted.

I hereby certify that the hound identified above has completed the requirements for the title indicated above (or that the required Certification was previously submitted) and that the information provided on this form is true and correct.

Signature: \_\_\_\_\_ Date: \_\_\_\_\_

Owner or Authorized Agent of Hound

Breed: SILKEN WINDHOUND		Call Name:	
Registered Name of Hound:			
Stake: <input type="checkbox"/> Open <input type="checkbox"/> FCH <input type="checkbox"/> Veteran <input type="checkbox"/> Single <input type="checkbox"/> Provisional		Additional Stakes <input type="checkbox"/> Kennel <input type="checkbox"/> Breeder <input type="checkbox"/> Bench	
Registration Number: (please write in registering body before number)			
<input type="checkbox"/> If possible, please separate my hounds	Date of Birth:	Sex: <input type="checkbox"/> Dog <input type="checkbox"/> Bitch	
Name of actual owner(s):			
Address:		Phone:	
City:		State:	Zip:
E-mail (Optional)		(Optional) Region of Residence:	
Emergency Contact Name and Phone (Optional)			
<input type="checkbox"/> Check if this is the first ASFA trial for this hound. Attach a Hound Certification or waiver if entered in Open, Veterans, Provisional.			
<input type="checkbox"/> Check if this is a first-time entry, a copy of the official Registration of this hound must accompany this entry unless NGA.			
<input type="checkbox"/> Check if any information has changed since the last ASFA trial entry. Regarding _____			
<input type="checkbox"/> Check if this hound has been dismissed within the last 6 trials entered. Must be marked in order to qualify for a "clean" trial requirement.			

I CERTIFY that I am the actual owner of this dog, or that I am the duly authorized agent of the actual owner whose name I have entered above. In consideration of the acceptance of this entry and the opportunity to have this dog judged and to win prize money, ribbons, or trophies, I (we) agree to abide by the rules and regulations of the American Sighthound Field Association in effect at the time of this lure field trial, and by any additional rules and regulations appearing in the premium list for this lure field trial. I (we) agree that the club holding this lure field trial has the right to refuse this entry for cause, which the club shall deem to be sufficient. I (we) agree to hold this club, its members, directors, governors, officers, agents or other functionaries, any employees of the aforementioned parties and the owner(s) of the trial premises or grounds harmless from any claim for loss or injury which may be alleged to have been caused directly or indirectly to any person or thing by the act of this dog while in or upon the lure field trial premises or grounds or near any entrance thereto and I (we) personally assume all responsibility and liability for any such claim, and I (we) further agree to hold the aforementioned parties harmless from any claim loss of this dog by disappearance, theft damage or injury be caused or alleged to be caused by the negligence of the club or any of the aforementioned parties or by the negligence of any person or any other cause or causes. I (we) certify and represent that the dog entered is not a hazard to person or other dogs. This entry is submitted for acceptance of the forgoing representations and agreements.

**SIGNATURE** of owner or his agent  
 duly authorized to make this entry \_\_\_\_\_

**Please separate the entries before submitting to FTS.**



## “Big Pretty”

Northwestern 24 acre field with some terrain and great views.



## Cabin

Off-grid cabin with loft and fenced dog yard potentially available for camping. Contact FTS for details and availability.



14

## COVID-19 Guidelines

1. GASM, its club members and all exhibitors will follow [State](#) and [local](#) guidelines.
2. Any unvaccinated Field Committee members and Lure Operators will wear facial coverings and gloves.
3. All unvaccinated participants must wear facial coverings.
4. The roll call committee will wear facial coverings. We will ask the owners of females to wipe their dogs and show the inspection committee the tissue.
5. The temperatures of exhibitors may be checked during Roll Call or when in question using a forehead, no-touch thermometer. Anyone with a temperature of 100.4°F or higher will be considered febrile and asked to leave the property.
6. Wickets will be wiped down after each dog.
7. We will have hand washing stations, instant hand sanitizer or wet wipes in various locations for use.
8. We will prop open the portipotties when not in use for more air flow.
9. Huntmasters will stand 6 feet from the dogs, inspecting blankets and slip leads.
10. At the starting line, all exhibitors will stand 6 feet apart from one another.
11. Practice social distancing the best you can.
12. While the running order and scores will be posted as usual, we ask that exhibitors approach the sheets one at a time and maintain social distance guidelines.
13. We will also post running orders and scoresheets on our Facebook page: <https://www.facebook.com/GazehoundAssocSmkyMtns/>
14. No self-serve ribbons anymore due to cross contamination.
15. If any payments need to be made, a PayPal to [paypal@gasm.club](mailto:paypal@gasm.club) will be accepted.
16. Exhibitors who refuse to comply when reasonably asked to follow mask, sanitary or social distancing guidelines will be removed from the property.



15





Gazehound Association of the Smoky Mountains

**Eddie Kominek, FTS**

**123 Glendale Rd.**

**Limestone, TN 37681**